

### Overview

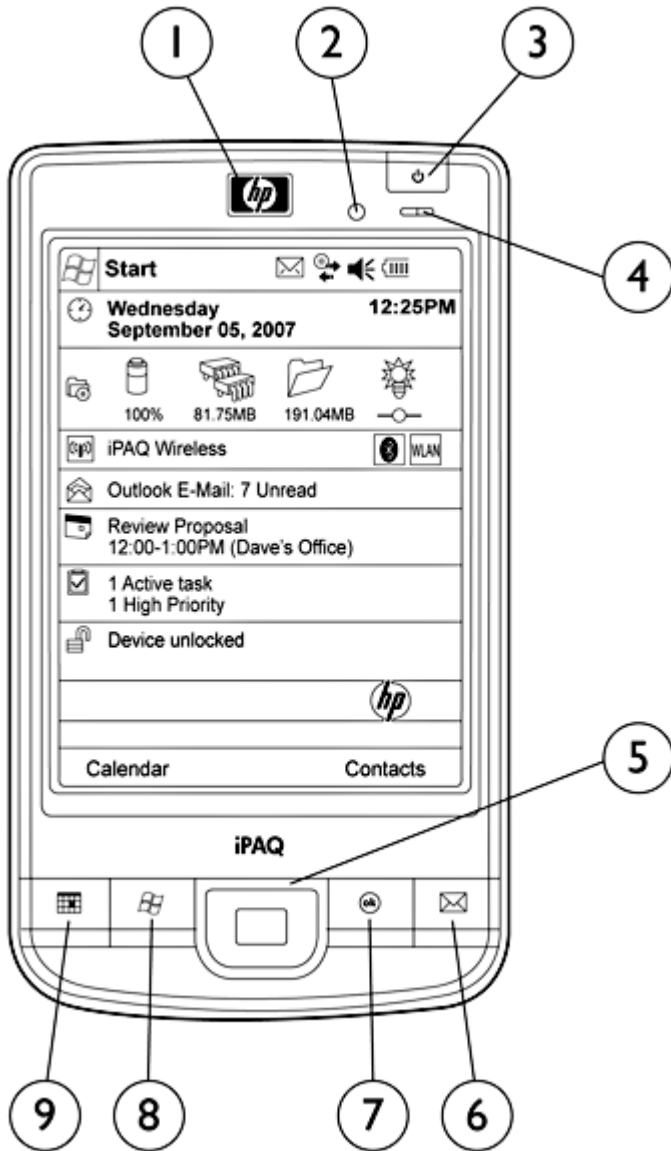

Front

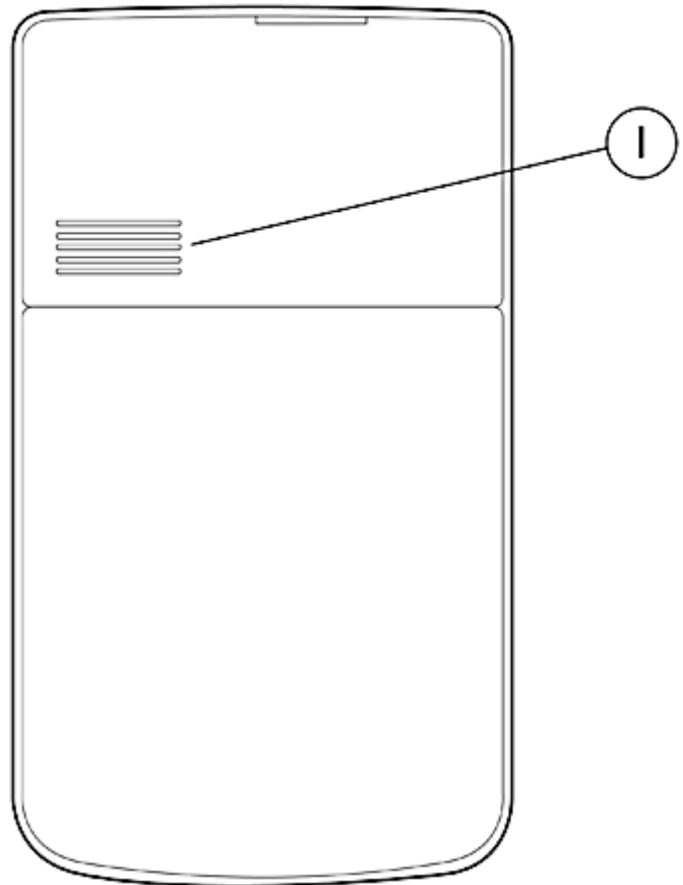

Back

1. Receiver
2. Light sensor
3. Power on/off
4. Power/wireless indicators
5. 5-way navigation; press to activate
6. Messaging (press) or Windows Media Player (press/hold)
7. OK or close screen (press), rotate screen (press/hold)
8. Launch Start menu (press) or Today screen (press/hold)

1. Speaker

### Overview

9. Launch calendar (press) or contacts (press/hold)

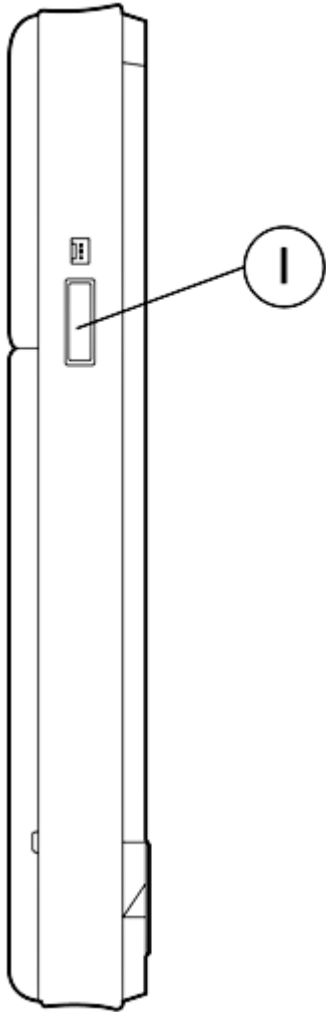

Left Side

1. Voice record button

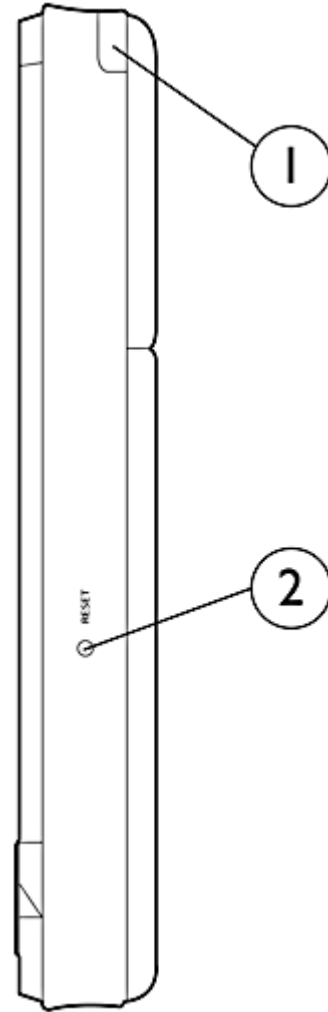

Right Side

1. Stylus
2. Reset

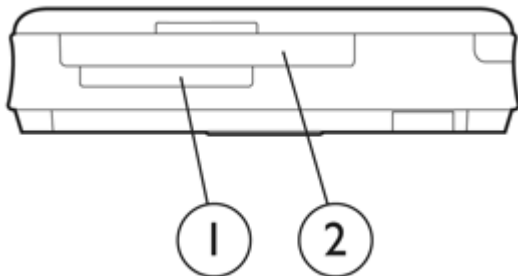

Top

1. SDIO slot
2. CompactFlash HC slot

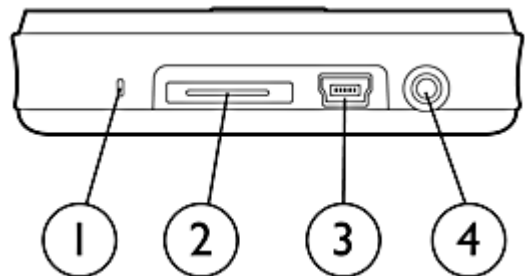

Bottom

1. Microphone
2. 24-pin connector
3. Mini-USB port

### Overview

#### 4. Headphone jack

### At A Glance

- Processor: Marvell PXA310, 624 MHz
- ROM: 256MB
- RAM: 128MB for running applications
- Display: 4-inch VGA TFT with touch screen, portrait oriented
- Wireless LAN: IEEE 802.11b/g with WEP through WPA2-Enterprise (EAP-TLS and PEAP) and WiFi Multimedia<sup>1</sup>
- Bluetooth: v2.0 with EDR<sup>1</sup>
- Connectors: 24-pin connector and Mini USB
- Battery: 2200 mAh
- Expansion: SDIO (high-capacity), CompactFlash HC
- Headphone jack: 3.5mm -3 or 4-pin
- Speaker: 1
- Receiver: 1
- Microphone: 1
- Input: touch, stylus
- Buttons: 5-way navigation with press to activate, 4 programmable, voice recorder, power, reset
- LED: 2
- Operating System: Windows Mobile® 6 Classic Edition

<sup>1</sup> A standard WLAN infrastructure, other Bluetooth-enabled devices, separately purchased equipment, and a service contract with a wireless airtime provider may be required for applicable wireless communication. Wireless Internet use requires a separately purchased service contract. Check with service provider for availability and coverage in your area. Not all web content available.

### Standard Features

#### Models

##### HP iPAQ 210 Enterprise Handheld

FB040AA#ABA	United States, Puerto Rico
FB040AA#ABC	Canada
FB041AA#ABA	United States, Puerto Rico, Aruba, Antigua/Barbuda, Bahamas, Barbados, Bermuda, British Virgin Islands, Cayman Islands, Grenada, Guadeloupe, Martinique, Nether Antilles, St. Kitts, St. Vincent, Trinidad Tobago, US Virgin Islands

##### HP iPAQ 212 Enterprise Handheld

FB042AA#AB0	Taiwan
FB042AA#AB1	South Korea
FB042AA#AB2	China
FB042AA#AB5	Hong Kong
FB042AA#ABG	Australia, New Zealand
FB042AA#ABJ	Japan
FB042AA#ARE	Malaysia
FB042AA#UUF	Singapore, Indonesia, Thailand, Philippines, Vietnam, Hong Kong, Bangladesh, Bhutan, Brunei, Cambodia, East Timor, Guam, Laos, Maldives, Pakistan, Sri Lanka, Nepal
FB042AA#ACJ	India

##### HP iPAQ 214 Enterprise Handheld

FB043AA#ABB	Austria, Belgium, Czech Republic, Denmark, Estonia, Finland, France, Germany, Greece, Hungary, Iceland, Ireland, Israel, Italy, Latvia, Liechtenstein, Lithuania, Luxembourg, Netherlands, Norway, Poland, Portugal, Romania, Slovakia, Slovenia, South Africa, Albania, Algeria, Bahrain, Benin, Bulgaria, Cameroon, Egypt, Ghana, Guinea, Jordan, Kuwait, Lebanon, Liberia, Morocco, Nigeria, Syria, Malta, Cyprus, UK, Northern Ireland
FB043AA#ABD	Germany, Austria, Switzerland
FB043AA#ABE	Spain, Portugal
FB043AA#ABF	France
FB043AA#ABH	Netherlands, Belgium
FB043AA#ABZ	Italy
FB043AA#ACB	Russia

##### HP iPAQ 214 Enterprise Handheld – top value

FB043AT#ABB	Austria, Belgium, Czech Republic, Denmark, Estonia, Finland, France, Germany, Greece, Hungary, Iceland, Ireland, Israel, Italy, Latvia, Liechtenstein, Lithuania, Luxembourg, Netherlands, Norway, Poland, Portugal, Romania, Slovakia, Slovenia, South Africa, Albania, Algeria, Bahrain, Benin, Bulgaria, Cameroon, Egypt, Ghana, Guinea, Jordan, Kuwait, Lebanon, Liberia, Morocco, Nigeria, Syria, Malta, Cyprus, UK, Northern Ireland
FB043AT#ABD	Germany, Austria, Switzerland
FB043AT#ABE	Spain, Portugal
FB043AT#ABF	France
FB043AT#ABH	Netherlands, Belgium

### Standard Features

FB043AT#ABZ	Italy
FB043AT#ACB	Russia

### HP iPAQ 216 Enterprise Handheld

FB044AA#AC4	Brazil
FB044AA#AC8	Argentina
FB044AA#B16	Mexico, Colombia, Chile, Costa Rica, Bolivia, Dominican Republic, Ecuador, El Salvador, Honduras, Haiti, Jamaica, Nicaragua, Panama, Paraguay, Peru, Puerto Rico, Uruguay, Venezuela, Belize, Guatemala, French Guiana, Guyana, Suriname

---

<b>Processor</b>	Marvell PXA310, 624 MHz <b>NOTE:</b> Processor numbering is not a measurement of higher performance.
------------------	---

---

<b>Memory</b>	128 MB SDRAM main memory for running applications 256 MB flash ROM
---------------	---

---

<b>Display</b>	<b>Type</b>	Transflective color TFT with backlight
	<b>Number of Colors</b>	65K, 16-bit
	<b>Touch Screen</b>	Yes
	<b>Resolution (H x W)</b>	640 x 480 pixels
	<b>Pixel Pitch</b>	127.5um(V), 42.5um(H)
	<b>Viewable Image Size</b>	4.0-inch diagonal

---

<b>System Unit</b>	<b>Dimensions (H x W x D)</b>	5.27 x 2.97 x 0.69 in. (133.9 x 75.4 x 17.5 mm)		
	<b>Weight</b>	6.7 oz (190 g)		
	<b>Operating Temperature</b>	23° to 113° F (-5° to 45° C)		
	<b>Storage Temperature</b>	-4° to 140° F (-20° to 60° C)		
	<b>Operating Humidity</b>	30~85% RH		
	<b>Regulatory Marks</b>	<b>Electrical</b>	FCC, C.I.S.P.R, V.C.C.I. Ministry of Commerce, ICES, Australian ACA , Taiwan BSMI, China CCIB, Canadian, Korea RRL, CE)	
		<b>Safety</b>	UL, NOM, European Laser, EVPU, SASO, Taiwan, US/Canada, CE	

---

<b>Hardware Buttons</b>	5-way navigation with press to activate; 4 programmable keys; voice recorder, power, and reset buttons
-------------------------	--

---

<b>Audio</b>	Headphone jack: 3.5mm support for stereo headset (3pin or 4pin) Speaker, microphone
--------------	--

---

### Standard Features

Indicators	Alarms	Solid amber power button – battery charging Solid green power button – battery fully charged Solid blue LED – WLAN and/or Bluetooth active
	Notification	Sound and visual message on the display
Connectors/ Interface(s)	24-pin connector, Mini USB	
Expansion	SDIO and CompactFlash card slots	
Power	Battery	Removable/rechargeable 2200 mAh Lithium Ion battery <b>NOTE:</b> Battery run time varies based on the usage pattern of an individual user and the configuration of the handheld. Use of internal wireless capabilities and backlight will significantly decrease battery run time.
	AC power supply ratings	AC Input: 100~240 Vac, 50/60 Hz AC Input current: 0.3 A max (for 120Vac); 0.15A max (for 240Vac) Output Voltage: 5.0Vdc (typical), Output Current: 2A (typical)
	AC adapter dimensions (HxWxD)	1.8 x 2.8 x 1.2 in (45 x 71.1 x 29.8 mm) (May vary by model)
	Power cord length (approx)	5.9 ft (1.8 m)
In the Box	iPAQ 200 Series Enterprise Handheld, sync/charge cable, multi-prong AC charger with appropriate plug adapter for shipping countries, battery, stylus, slip case, documentation kit, and HP iPAQ Companion CD	
Operating System	Windows Mobile® 6 Classic Edition	
Applications/Links	Windows Mobile Office Outlook Windows Mobile Office Internet Explorer Mobile File Explorer Windows Media Player 10 Windows Live Messenger Client Internet Sharing Microsoft ActiveSync Windows Mobile Device Center Games (Bubble Breaker, Solitaire) Calculator Picture/Video Viewer	<b>HP Value-Add Applications:</b> iPAQ Wireless Manager HP Photosmart Mobile HP QuickStart Tour HP iPAQ Tips ClearVue PDF Today Panel Lite Today Panel Lite Bluetooth Manager Bluetooth Phone Manager HP Asset Viewer HP CertEnroller iPAQ Audio Backlight Charging Applets

**NOTE:** Programs may vary based on model. Some programs are accessed through CD links to download web sites.

### Standard Features

---

**Service and Support** One year parts and labor in most regions; 90 days technical support for software in most regions.  
HP Business Support Center

- iPAQ Active Chat support 24x7
- Email-based support service
- On-line troubleshooting and self-help resources

**NOTE:** Additional offers may vary by region.

---

<b>Wireless LAN Specifications</b> <sup>1,2</sup>	<b>IEEE standard(s)</b>	802.11 b/g
	<b>Frequency band</b>	2.4000 to 2.497 GHz
	<b>Antenna type</b>	PIFA Antenna
	<b>Modulation technique</b>	802.11b CCK Mode3, 802.11g OFDM
	<b>Receiver sensitivity – packet error rate</b>	1 Mbps: <-93 dBm, PER < 8%, typical 11 Mbps: <-87 dBm, PER < 8%, typical 54 Mbps: <-72 dBm, PER < 10%, typical
	<b>Transmit output power</b>	14.0 dBm (typical 802.11b) 12 dBm (typical 802.11x)
	<b>Power consumption</b>	Transmit mode: 0.99 Watts, typical Receive mode: 0.99 Watts, typical
	<b>Operating distance</b>	Up to 300 feet – open sight

---

<b>Bluetooth® Specifications</b> <sup>1</sup>	<b>Technology</b>	High-speed, low-power, short-range wireless communication with other Bluetooth devices
	<b>Specification</b>	Bluetooth 2.0 with EDR (2.4 GHz Industrial Scientific Medical Band)
	<b>System interface</b>	UART
	<b>Device type</b>	Class 2; up to 4 dBm transmit, typical 10 meter range
	<b>Power</b>	Typical TX current at approximately 56 mA Typical RX current at approximately 45 mA

---

<b>Regulatory Compliance</b>	<b>Certifications</b>	UL, FCC, Industry Canada, CE, C-Tick, CCC, RTA, NTC, IDA, DGT, SIRIM, PTA, GOST, SASO, SABS, JTB, WPC, DGPT, MoC, ICASA, Etisalat, VCCI, MIC
	<b>RoHS or WEE compliance</b>	

---

<sup>1</sup> A standard WLAN infrastructure, other Bluetooth-enabled devices, separately purchased equipment, and a service contract with a wireless airtime provider may be required for applicable wireless communication. Wireless Internet use requires a separately purchased service contract. Check with service provider for availability and coverage in your area. Not all web content available.

### Options

**NOTE:** Optional accessories are available as separate purchase.

---

<b>Power</b>	HP iPAQ 200 Series Standard Battery (2200 mAh)	FB036AA#AC3
	HP iPAQ 200 Series Extended Battery (3800 mAh)	FB037AA#AC3
	AC Adapter 10W(5V 2A)	FA372B#AC3
	HP iPAQ Travel Kit – Mini-USB	FA804AA#AC3
	HP iPAQ Auto Adapter – Mini-USB	FA765AA#AC3

---

<b>Synchronization/ Cradle</b>	HP iPAQ 200 Series Sync/Charge Cable	FB072AA#AC3
	HP iPAQ 200 Series Enhanced Sync/Charge Cable	FB112AA#AC3
	HP iPAQ 200 Series Desktop Cradle	FB035AA#AC3

---

<b>Headphones</b>	HP iPAQ Stereo Wired 3.5mm Headset	FB033AA#AC3
	HP iPAQ Bluetooth (Mono)Headset	Please check hp.com

---

<b>Cases</b>	HP iPAQ 200 Series Skin Fit Case	FB016AA#AC3
	HP iPAQ 200 Series Belt Case	FB014AA#AC3
	HP iPAQ 200 Series Semi-Rugged Case	FB017AA#AC3

---

<b>Other Accessories</b>	HP iPAQ 200 Series Screen Protector	FB019AA#AC3
	HP iPAQ 200 Stylus Kit	FB020AA#AC3
	HP iPAQ Universal Car Cradle	FA920AA#AC3

---

### NOTES:

<sup>1</sup> A standard GSM/GPRS/EDGE/UMTS/HSDPA infrastructure, Wi-Fi, other Bluetooth-enabled devices, separately purchased equipment, and a service contract with a wireless airtime provider may be required for applicable wireless communication. Wireless Internet access requires separately purchased Internet service contract. Check with service provider for availability and coverage in your area. Not all web content available. Wireless transmission speeds may vary based upon network capabilities and other conditions. Establishment and continuation of a wireless connection depends on network availability, provider support and signal strength.

<sup>2</sup> Telephone service requires separately purchased contract with a telephone service provider with coverage in your service area. Additional fees may apply for some features, check with your service provider.

<sup>3</sup> Wireless access point required and is not included. Availability of public wireless access points is limited. Wireless Internet use may require separately purchased Internet service contract.

For more information on the HP iPAQ 200 Series Enterprise Handheld, visit <http://www.hp.com>.

©Copyright 2008 Hewlett-Packard Development Company, L.P. The information contained herein is subject to change without notice. The only warranties for HP products and services are set forth in the express warranty statements accompanying such products and services. Nothing herein should be construed as constituting an additional warranty. HP shall not be liable for technical or editorial errors or omissions contained herein. Microsoft and Windows are U. S. registered trademarks of Microsoft Corporation. Windows Vista is either a registered trademark or trademark of Microsoft Corporation in the United States and/or other countries. Bluetooth is a trademark owned by its proprietor and used by Hewlett-Packard Company under license.

## Options