

### Overview

#### What's New

- Intel® Pentium® 4 processors
- Intel 845 chipset
- New *Evo*™ industrial design with carbon and silver colour
- New Small Form Factor and Desktop chassis

#### At A Glance

- Intel Pentium 4 processors with 400-MHz Front Side Bus
- Choice of three form factors
- Compaq Intelligent Manageability
- Energy Star compliant with energy-saving features
- Windows® XP Ready
- Protected by Compaq Services, including a three-year, limited warranty – Terms and conditions vary by country. Certain restrictions and exclusions apply. For details, consult the Product Information Centre at 1-888-88-COMPAQ.

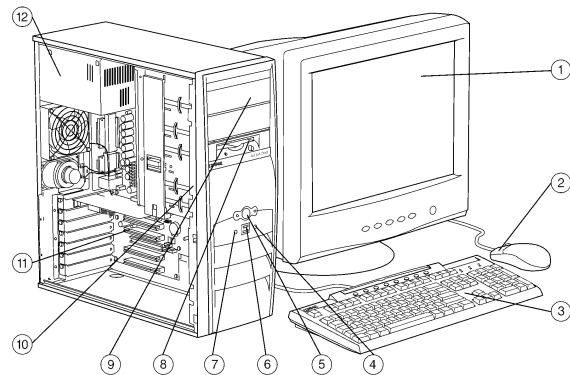

#### Convertible Minitower

1. CRT Monitor (sold separately)
2. 2-Button Scroll Mouse
3. Easy Access Keyboard
4. Microphone Connector (optional)
5. Dual-State Power Button
6. USB Connector (optional)
7. Headphone Connector (optional)
8. 1.44-MB Diskette Drive
9. 2 External Expansion Bays
10. SMART III Ultra ATA/100 Hard Drive
11. Expansion Slots
12. 250-Watt Power Supply

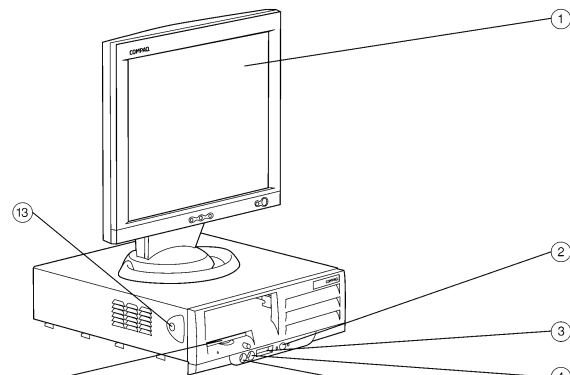

#### Small Form Factor

1. TFT Monitor (sold separately)
2. Dual-State Power Button
3. USB Connectors
4. Headphone Connector
5. Microphone Connector
6. SMART III Ultra ATA/100 Hard Drive
7. 2-Button Scroll Mouse
8. Easy Access Keyboard
9. CD-ROM Drive
10. Expansion Slots
11. 175-Watt Power Supply
12. 1.44-MB Diskette Drive
13. Quick Release Cover Latch

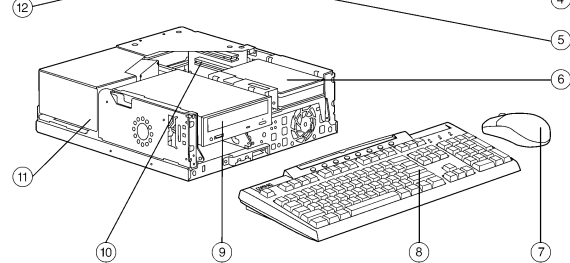

#### Desktop

1. TFT Monitor (sold separately)
2. 1.44-MB Diskette Drive
3. Dual-State Power Button
4. USB Connector (optional)
5. Microphone Connector (optional)
6. Headphone Connector (optional)
7. CD-ROM Drive
8. External Expansion Bay
9. 2-Button Scroll Mouse
10. Easy Access Keyboard
11. 235-Watt Power Supply
12. Expansion Slots

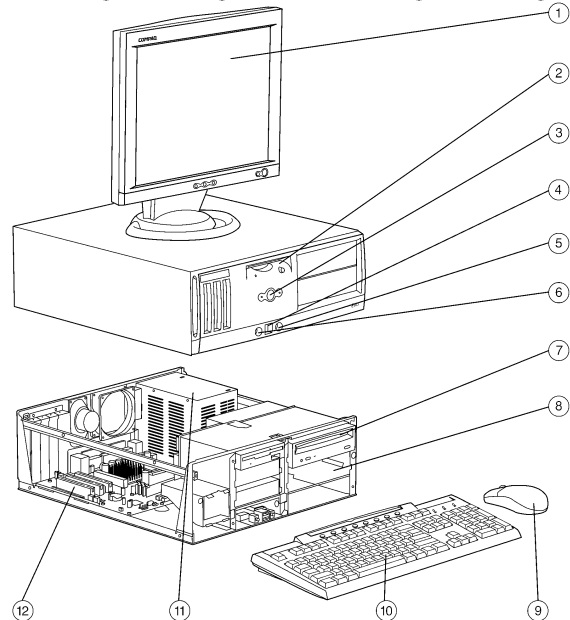

## Standard Features – Select Models

### Compaq Evo Desktop D500 Series with 845 chipset

#### Pre-Configured Models

#### Model Key

#### Example:

**D5S/P1.5/20/2/128c**

D5S =	Evo D500 Small Form Factor
D5D =	Evo D500 Desktop
D5C =	Evo D500 Convertible Minitower
P1.5 =	Pentium 4 1.5-GHz processor
20 =	Hard Drive
P =	Microsoft® Windows XP Pro/2000 Dual Install
6 =	Microsoft Windows 2000/NT dual install
8 =	Microsoft Windows 98 SE
128 =	Memory
c =	CD-ROM

#### All Evo D500 P4 SKUs contain:

- Intel Integrated Audio
- Integrated Intel Pro/100 VM Network Connection
- NVIDIA® Vanta 16-MB 4X AGP
- Intel 845 Chipset

#### Celeron models contain:

- Intel integrated graphics
- Intel 815E chipset
- Integrated Intel Pro/100 VM NIC

#### Small Form Factor

D5S/P1.5/20/8/128c  
D5S/P1.5/20/6/128c  
D5S/P1.5/20/6/256c  
D5S/P1.7/20/6/256c  
D5S/P1.7/20/8/256c  
D5S/P1.7/20/P/256c  
D5S/P1.8/20/P/128c  
D5S/P1.8/20/P/256c  
D5S/P2.0/40/P/256c  
D5S/P1.7/20/8/128c  
D5S/P1.7/20/6/128c

#### English

470023-298  
470023-301  
470023-311  
470023-312  
470024-186  
470022-015  
470028-786  
470029-268  
470031-643  
470022-012  
470022-014

#### French

470023-299  
470023-305  
470023-313  
470023-314  
470024-187  
470022-025  
470028-787  
470029-273  
470031-646  
470022-022 (special order only)  
470022-024 (special order only)

#### Convertible Minitower

D5C/P1.5/20/8/128c  
D5C/P1.5/20/6/128c  
D5C/P1.5/20/6/256c  
D5C/P1.7/20/8/128c  
D5C/P1.7/20/6/256c  
D5C/P1.7/20/P/256c  
D5C/P1.8/20/P/256c  
D5C/P2.0/40/P/256c

470023-190  
470023-191  
470023-192  
470022-068  
470023-193  
470022-071  
470028-721  
470031-641

470023-194  
470023-195  
470023-196  
470022-083  
470023-197  
470022-086  
470028-695  
470031-644

#### Desktop

D5D/P1.5/20/8/128c  
D5D/P1.5/20/6/128c  
D5D/P1.7/20/8/256c  
D5D/P1.7/20/6/256c  
D5D/P1.8/20/P/256c  
D5D/P2.0/40/P/256c  
D5D/P1.5/20/6/256c  
D5D/1.7/20/8/128c  
D5D/1.7/20/6/128c  
D5D/1.7/20/6/256c

470023-200  
470023-201  
470024-180  
470024-181  
470028-927  
470031-642  
470021-642  
470021-666  
470021-668  
470021-670

470023-198  
470023-199  
470024-182  
470024-183  
470028-933  
470031-645  
470021-671 (special order only)  
470021-661 (special order only)  
470021-663 (special order only)  
470021-665 (special order only)

## Standard Features – Select Components

---

### Compaq Evo Desktop D500 Series with 845 chipset

---

<b>Processor and Speed</b>	<b>Intel Pentium 4 Processors</b>	<b>Standard L2 Cache</b>	256-KB Integrated ECC (1.5 and 1.7)
<i>One of the following</i>	1.5-GHz		512-KB Integrated ECC (2.0)
	1.7-GHz	<b>Front Side Bus</b>	400-MHz
	2.0-GHz*	<b>Maximum Memory</b>	3-GB

Note: \*Intel Pentium 4 processors with speeds of 2.0-GHz or above have 512-KB L2 cache.

---

<b>Hard Drives</b>	20-GB (7200RPM) QSI SMART III Ultra ATA/100
	40-GB (7200RPM) QSI SMART III Ultra ATA/100

---

---

<b>Standard Memory</b>	256-MB SDRAM (PC133)
<i>One of the following</i>	128-MB SDRAM (PC133)

---

---

<b>Removable Storage</b>	1.44-MB Diskette Drive
--------------------------	------------------------

---

---

<b>Optical Storage</b>	48X CD-ROM Drive
------------------------	------------------

---

---

<b>Keyboard/Mouse</b>	Easy Access Keyboard
	2-Button Scroll Mouse

---

---

<b>Audio</b>	Integrated AC97 Audio with Internal Speaker
--------------	---

---

---

<b>NIC</b>	Integrated Intel PRO/100 VM Network Connection
------------	--

---

---

<b>Graphics</b>	NVIDIA Vanta 16-MB 4X AGP
-----------------	---------------------------

---

---

<b>Operating System</b>	Microsoft Windows XP Pro
<i>One of the following</i>	Microsoft Windows 2000 SP2
	Microsoft Windows NT® 4.0 SP6a
	Microsoft Windows 98 SE

---

---

<b>Intelligent Manageability</b>	Yes
----------------------------------	-----

---

## Standard Features – Base Unit Details

### Compaq Evo Desktop D500 Series with 845 chipset

Expansion Capability	Desktop	Small Form Factor	Convertible Minitower
Memory Expansion Slots	3 DIMMs	3 DIMMs	3 DIMMs
<b>Slots</b>			
PCI	3	2 (on Riser)	5 (3 on PCA, 2 via PCI Extender Card)
AGP	1 (1.5V AGP 4X)	1 Low Profile AGP (1.5V AGP 4X)	1 (1.5V AGP 4X)
<b>Bays</b>			
Internal	(2) HDD	(1) HDD	(2) HDD
External	(2) 5.25" 1/2 ht (1) Floppy	(1) 5.25" 1/2 ht (1) Floppy	(2) 5.25" 1/2 ht (1) Floppy
<b>Dimensions (H x W x D)</b>	<b>Desktop</b>	<b>Small Form Factor</b>	<b>Convertible Minitower</b>
Inches	5.72 x 15.25 x 17.9 inches	3.9 x 13.1 x 14.4 inches	17.65 x 6.6 x 16.8 inches
Centimetres	14.5 x 38.7 x 45.5 centimetres	9.9 x 33.3 x 36.6 centimetres	44.8 x 16.8 x 42.7 centimetres
<b>System Weight</b>	25 lb/11.34 kg	20 lb/9.1 kg	26.0 lb/11.8 kg
Weight Supported	100 lb/45.5 kg	100 lb/45.5 kg	100 lb/45.5 kg
<b>System Memory</b>	Type/Speed	SDRAM DIMM - PC133 Only	
	Maximum Memory	3-GB	
	Memory Parity	Not Supported	
	ECC Memory	Supported (Intel 845 chipset does not support mixing of Non-ECC and ECC PC133 memory)	
	Serial Presence Detect Support	Mandatory as part of PC133 Spec	
<b>Supported Features</b>	Processor	Intel Socket 478	
	CPU Bus Speed Supported	400-MHz	
	Memory Type Supported	SDRAM	
	Memory Speed Supported	PC133 Only	
	SPD Support	Yes	
	Hard Drive Interfaces Supported	SMART Ultra ATA/100/66/33	
	Hard Drive Controller (PCI) Interfaces Supported	SMART Ultra ATA/100/66/33	
<b>Intel Pentium 4</b>	Coprocessor	Yes	
	CPU Socket Type/Number	Surface Mount ZIF Socket - 478 Pins	
	CPU Package	mPGA478B, FC-PGA2	
	Front Side Bus Speed	400-MHz	
	Standard L2 Cache	256K	
	L2 Cache Architecture/Speed	Advanced Transfer Cache on Die with 8-way associativity and Error Correcting Code (ECC)/Full Speed of Processor	

## Standard Features – Base Unit Details

### Compaq Evo Desktop D500 Series with 845 chipset

System Board	<b>Architecture</b>	P4/PCI/AGP 4X
	<b>Chipset</b>	Intel 845 Chipset
	<b>I/O Controller</b>	Super I/O 3
	<b>System Board Form Factor</b>	Standard uATX on Desktop Custom on Small Form Factor Standard uATX + PCI Extender Board on Convertible Minitower
	<b>Processor Socket - 478 Pin ZIF</b>	Yes
	<b>DIMM Connectors</b>	Yes (3)
	<b>AGP Connector</b>	Yes (1)
	<b>AGP Integrated</b>	No
	<b>PCI Connectors</b>	Desktop (3) Small Form Factor (2 on Riser) Convertible Minitower (5 standard)
	<b>Flash ROM</b>	Yes
	<b>Audio (ADI 1885 - AC97)</b>	Yes
	<b>CD ROM IN (Audio)</b>	Yes
	<b>Clear CMOS Button</b>	Yes
	<b>CPU Fan Header</b>	Yes (not installed on D500 Small Form Factor)
	<b>Chassis Fan Header</b>	Yes
	<b>Chassis Speaker Header</b>	Yes
	<b>CMOS Battery Holder - Lithium</b>	Yes
	<b>NIC</b>	Yes
	<b>Wake-On-Lan®</b>	Yes
	<b>Alert-On-LAN®</b>	Yes
	<b>Power Supply Header</b>	Yes
	<b>Power Switch, Power LED and HD LED Header</b>	Yes (on systemboard on D500 Small Form Factor)
	<b>Password Clear Header</b>	Yes
	<b>Reset Header (Not Installed)</b>	Yes
	<b>Riser Connector</b>	Yes on D500 Small Form Factor only
	<b>SCSI LED Header</b>	Yes (on riser on D500 Small Form Factor)
	<b>Speaker Header</b>	Yes
<b>Boards that connect to System Board</b>	Desktop Small Form Factor Convertible Minitower	Solenoid Lock PCB (Option), Front I/O Board (Option) Solenoid Lock PCB (Option), Riser board - 2 PCI Slots Solenoid Lock PCB (Option), PCI Extender Board - 2 additional PCI Slots, Front I/O Board (Option)

## Standard Features – Base Unit Details

### Compaq Evo Desktop D500 Series with 845 chipset

<b>Serviceability Features of System Board</b>	<ul style="list-style-type: none"> <li>Dual Colour Power and HD LED - To Indicate Normal Operations and Fault Conditions</li> <li>Blinking Diagnostic Keyboard LED Codes</li> <li>Diagnostic LED Label under Hood Cover</li> <li>User Diagnostic Software Support</li> <li>Over-Temp Warning on Screen (Need Intelligent Manageability to work)</li> <li>Compaq Software Restore CD</li> <li>Flash ROM</li> <li>3.3V Aux Power LED on System PCA</li> <li>Dual Function 5V Aux Power LED (ON) /PS_ON LED (OFF) on System PCA</li> <li>Processor Hot LED on System PCA</li> <li>Diagnostic Power Switch LED (Not needed onD500 Small Form Factor because power switch is on system board)</li> <li>Clear Password Jumper</li> <li>Clear CMOS Button</li> </ul>
--	---

<b>Desktop Chassis</b>	<ul style="list-style-type: none"> <li>Colour: Silver/Carbon</li> <li>System Board Form Factors Supported: Standard uATX</li> <li>Cooling Solutions Supported (3 Fans): Variable Speed Power Supply Fan, Variable Speed Processor Fan Heatsink, Variable Speed Chassis Fan</li> <li>Slots Supported: 3 Full Length, Full Height PCI Slots, 1 Half Length, Full Height AGP</li> <li>Front I/O: Front Headphone, Mic, and 2 USB (Option)</li> <li>Rear I/O: Standard ATX I/O Panel</li> <li>Internal Speaker: Yes</li> <li>Custom Power Supply: 235-Watt Enhanced ATX PS</li> <li>Security Locks Supported: Kensington Cable Lock, Security Module (Solenoid Hood Lock and Hood Sensor) – option, Lock Tab built into back of Chassis</li> <li>Power Switch/LED Cable: Yes</li> </ul>
------------------------	---

<b>Small Form Factor Chassis</b>	<ul style="list-style-type: none"> <li>Colour: Silver/Carbon</li> <li>System Board Form Factors Supported: Custom SFF</li> <li>Cooling Solutions Supported (2 Fans): Variable Speed Power Supply Fan, Variable Speed Chassis Fan</li> <li>Slots Supported: 2 Half Length, Full Height PCI slots, 1 Low Profile AGP</li> <li>Front I/O: Front Headphone, Mic, and 2 USB Standard</li> <li>Rear I/O: Standard ATX I/O Connectors (Some Single Stacked)</li> <li>Internal Speaker: Yes</li> <li>Custom Power Supply: 175-Watt Enhanced ATX Like PS</li> <li>Security Locks Supported: Kensington Cable Lock, Security Module (Solenoid Hood Lock and Hood Sensor) – option</li> <li>Power Switch/LED Cable: No (on system board)</li> </ul>
----------------------------------	--

## Standard Features – Base Unit Details

### Compaq Evo Desktop D500 Series with 845 chipset

<b>Convertible Minitower Chassis</b>	Colour	Silver/Carbon
	System Board Form Factors Supported	Standard uATX and Standard ATX
	Cooling Solutions Supported (3 Fans)	Variable Speed Power Supply Fan Variable Speed Processor Fan Heatsink Variable Speed Chassis Fan
	Slots Supported	6 Full Length, Full Height Slots (1 AGP and 5 PCI)
	Front I/O	Front Headphone, Mic, and 2 USB (Option)
	Rear I/O	Standard ATX I/O Panel
	Internal Speaker	Yes
	Custom Power Supply	250-Watt Enhanced ATX PS
	Security Locks Supported	Kensington Cable Lock Security Module (Solenoid Hood Lock and Hood Sensor) – option Compaq Lock Bracket – 173234 (chassis securement only, hood lock required to secure hood)
	Power Switch/LED Cable	Yes

Serviceability Features of Chassis	Desktop	Small Form Factor	Convertible Minitower
Dual Colour Power and HD LED to Indicate Normal Operations and Fault Conditions	Yes	Yes	Yes
Diagnostic LED Label under Hood Cover	Yes	Yes	Yes
Security Module (Smart Cover Lock and Hood Sensor)	Optional	Optional	Optional
Front power switch	Yes	Yes	Yes
Green Pull Tabs, and Quick Release Latches for easy Identification	Yes	Yes	Yes
System memory can be upgraded without removing the system board or any internal components	Yes	Yes	Yes
Tool-less Hood Removal	Yes (with captive thumbscrew)	Yes (with side push buttons)	Yes (with captive thumbscrew)
Tool-less Hard Drive, CD and Floppy Removal	Yes	Yes	Yes
Tool-less System Board Removal	No	Yes	No
Industry Standard CD Bay	Yes	Yes	Yes
Towerable	Yes	Yes	Yes (Can also Rotate Drives)
Universal Tower Stand	Yes (Option)	Yes (Option)	No (Not needed)
Green Colour Coded Latches and Cable Pull Tabs for Easy Identification	Yes	Yes	Yes

## Standard Features – Base Unit Details

### Compaq Evo Desktop D500 Series with 845 chipset

Interfaces	Desktop	Small Form Factor	Convertible Minitower
I/O Chip	Super IO 3	Super IO 3	Super IO 3
Serial Port/UART Type	Yes (2)/SN75185	Yes (2)/SN75185	Yes (2)/SN75185
Parallel Port	Yes	Yes	Yes
USB	2 USB 1.1 (Optional 2 Front USB)	4 USB 1.1	2 USB 1.1 (Optional 2 Front USB)
Infrared Port	No	No	No
Network	RJ-45 (with integrated LEDs)	RJ-45 (with integrated LEDs)	RJ-45 (with integrated LEDs)
Keyboard	Yes (PS/2)	Yes (PS/2)	Yes (PS/2)
Mouse	Yes (PS/2)	Yes (PS/2)	Yes (PS/2)
Video	Yes (AGP 4X 1.5V Bus)	Yes (AGP 4X 1.5V Bus)	Yes (AGP 4X 1.5V Bus)
Audio	Yes	Yes (Mic-In, Hphone Out, Line-In, Line-Out)	Yes
Power Supply	Desktop	Small Form Factor	Convertible Minitower
Full Ranging Input (No Line Select Switch)	Yes	Yes	Yes
Active Power Factor Correction (APFC) (Input Current is nearly ½ a non-APFC PS)	Yes	Yes	Yes
Operating Voltage Range	90 to 264VAC	90 to 264VAC	90 to 264VAC
Rated Voltage Range	100 to 240VAC	100 to 240VAC	100 to 240VAC
Rated Line Frequency	50-60 Hz	50-60 Hz	50-60 Hz
Rated Input Current	3.6A @ 100VAC	2.7A @ 100VAC	3.6A @ 100VAC
Maximum Rated Power	235W	175W	250W
Heat Dissipation	Max: 1,234 BTU/hr	Max: 920 BTU/hr	Max: 1,313 BTU/hr
	Nominal: 617 BTU/hr	Nominal: 460 BTU/hr	Nominal: 656 BTU/hr
	Max: 311 kg-cal/hr	Max: 232 kg-cal/hr	Max: 331 kg-cal/hr
	Nominal: 155 kg-cal/hr	Nominal: 116 kg-cal/hr	Nominal: 165 kg-cal/hr

## Standard Features – Base Unit Details

### Compaq Evo Desktop D500 Series with 845 chipset

Power Conservation 'Energy Saver'	Desktop	Small Form Factor	Convertible Minitower
Energy Star Compliant	Yes	Yes	Yes
Blue Angel Compliant (<5w in S5-Power Off)	Yes	Yes	Yes
Power Consumption in ES Mode - Suspend to RAM (S3) (Instantly Available PC)	TBD	-2W	TBD
APM Support	Yes	Yes	Yes
Screen Blanking	Yes	Yes	Yes
Hard Disk 'Idle' Mode	Yes	Yes	Yes
System Idle Mode	Yes	Yes	Yes
Processor/Cache Memory Power- Down (S3)	Yes	Yes	Yes
CD-Rom Spins Down when not in use	Yes	Yes	Yes

### ROM Features

Instantly Available PC (Suspend to RAM - S3)  
 ROM Based F10 Setup  
 Remote System Installation via F12 (PXE)  
 Failsafe Boot Block ROM  
 Emergency ROM Flash Recovery with Video  
 CMOS Archive and CMOS Restore  
 Save and Restore CMOS Setup via Diskette  
 Auto Setup when New Hardware Installed  
 Serial, Parallel, USB Enable/Disable Port Control  
 Removable Media Write/Boot Control  
 Remote Boot from Server  
 Network Server Mode  
 Power-On Password  
 Setup Password  
 Memory Change Alert (Need IM to work)  
 Thermal Alert (Need IM to work)  
 Cover Removal Alert (Need IM to work)  
 Master Boot Record Security  
 Remote ROM Flash  
 Remote Wakeup  
 Power Management  
 ACPI Ready  
 DMI BIOS (Desktop Management Interface)

## Standard Features – Base Unit Details

### Compaq Evo Desktop D500 Series with 845 chipset

System Environmental Specs		
	Operating Temperature	50° to 95°F/10° to 35° C (Derating of 1.0°C per 300m (1000ft) to 3000m (10,000ft), no direct sustained sunlight)
	Non-operating Temperature	-22° to 140° F -30° to 60° C (Maximum rate of change is 20°C/Hr.)
	Relative Humidity (non-condensing) Operating	10% to 90% (28°C maximum wet bulb temperature)
	Relative Humidity (non-condensing) Non-operating	5% to 95% (38.7°C maximum wet bulb temperature)
	Max Altitude (unpressurized) Operating	10,000 ft 3,048 m (Maximum allowable altitude change rate is 1500 ft/min)
	Max Altitude (unpressurized) Non-operating	30,000 ft 9,144 m (Maximum allowable altitude change rate is 1500 ft/min)
	Acoustics	ENERGY SAVE MODE: LWAd = TBD Bels, Desktop Average LpAm = TBD dBA FIXED DISK - SCSI (Random write): LWAd = TBD Bels, Desktop Average LpAm = TBD dBA
	Shock (Operating)	5 G
	Shock (Non-Operating)	20 G 10 G (positive and negative directions front to back on Small Form Factor)
	Vibration (Operating)	Operating: Random vibration at 0.000215 G <sup>2</sup> /Hz, 10Hz to 300Hz, (0.25G's nominal)
	Vibration (Non-Operating)	Random vibration at 0.0005 G <sup>2</sup> /Hz, 10Hz to 500Hz, (0.5G's nominal).

## Standard Features – Base Unit Details

### Compaq Evo Desktop D500 Series with 845 chipset

#### Software

Preinstalled Software	Desktop	Small Form Factor	Convertible Minitower
Microsoft Windows 98 SE	Yes	Yes	Yes
Microsoft Windows NT 4. SP6a	Yes	Yes	Yes
Microsoft Windows 2000 SP2	Yes	Yes	Yes
Microsoft Windows XP Pro	(when available from Microsoft)	(when available from Microsoft)	(when available from Microsoft)
Microsoft Windows XP Home	(when available from Microsoft)	(when available from Microsoft)	(when available from Microsoft)
Computer Setup Utility via F10 (ROM Based)	Yes	Yes	Yes
Diagnostics for Windows	Yes	Yes	Yes
Microsoft Internet Explorer	Yes	Yes	Yes
<b>Intelligent Manageability Agent</b>	Yes	Yes	Yes
<b>Plug and Play Ready</b>	Yes	Yes	Yes
Windows 98	Yes	Yes	Yes
Windows 2000	Yes	Yes	Yes
Windows XP Pro	Yes	Yes	Yes
Windows XP Home	Yes	Yes	Yes
Windows NT 4.0	Plug and Play not supported in Windows NT 4.0	Plug and Play not supported in Windows NT 4.0	Plug and Play not supported in Windows NT 4.0
<b>Boot Support</b>			
Local Diskette Boot	Yes	Yes	Yes
Local CD Boot	Yes	Yes	Yes
Remote Boot	Yes	Yes	Yes
Network Boot	Yes	Yes	Yes

**Intelligent Manageability** Information downloadable from: <http://www.compaq.com/im>  
Note: This Web site is available in English only.

**Initial Configuration and Deployment** Intelligent Manageability Home Page  
Altiris eXpress  
PC Transplant/PC Transplant PRO  
System Software Management  
Novel ZenWorks 2.0  
Insight Manager  
Support Software CD  
Compaq Software Restore CD

**Asset Control** Asset Tag  
DIMM Serial Presence Detect  
Hard drive serial number, model, and manufacturer  
Monitor serial number, model and manufacturer  
System serial number, model, and manufacturer  
ROM revision levels  
System board revision level  
Compaq Fingerprint Identification Technology (Optional)  
DMI BIOS  
Memory Change Alert (Intelligent Manageability needed to work)  
Ownership Tag  
Smart Cover Lock (Optional)  
Kensington Lock Support  
Smart Cover Sensor (Optional)

## Standard Features – Base Unit Details

---

### Compaq Evo Desktop D500 Series with 845 chipset

---

<b>Standard Security Features</b>	Asset Tracking and Security Home Page <a href="http://www.compaq.com/im/ats.html">http://www.compaq.com/im/ats.html</a> <i>Note: This Web site is available in English only.</i> Optional Smart Cover Lock Mechanical Security Provision Cable Lock Provision Power-On Password Serial, Parallel, USB Enable/Disable Removable Media Write/Boot Control Power-On Password Setup Password
-----------------------------------	---

---

<b>Software Updating and Management</b>	Software Updating and Management Home Page <a href="http://www.compaq.com/im/sum.html">http://www.compaq.com/im/sum.html</a> <i>Note: This Web site is available in English only.</i> Remote ROM Flash ROM Based Setup (F10) and Start-up Diagnostics Support Software CD and WWW Site
---	--

---

<b>Fault Notification and Recovery</b>	Fault Management Home Page <a href="http://www.compaq.com/im/fnr.html">http://www.compaq.com/im/fnr.html</a> <i>Note: This Web site is available in English only.</i> DMI BIOS SMART Hard Drives, Fault Notification, and Prefailure Warranty Proactive Backup ATA RAID Controller Option ECC Memory, Fault Notification, and Pre-failure Warning Processor Fault Notification and Prefailure Warranty (Not supported by P4 processor) Surge Tolerant Full Ranging Power Supply Thermal Sensor Ultra ATA Integrity Monitoring (CRC Checking) <i>Note: Certain restrictions and exclusions apply. For details, consult the Product Information Centre at 1-888-88-COMPAQ.</i>
--	---

---

<b>Other Features</b>	ACPI-Ready Hardware Compaq Insight Manager LC and XE Agents Altiris agent Compaq Management Solutions Partners Program Dual-State Power Button Compaq Management Solutions Partners Program Wired for Management Support
-----------------------	--

---

<b>Service and Support</b>	On-site Warranty and Service <i>Note 1</i> : This three-year, limited warranty and service offering delivers three years of on-site, next business-day <i>Note 2</i> service for parts and labour and includes free telephone support <i>Note 3</i> 24 x 7. Global coverage <i>Note 2</i> ensures that any product purchased in one country and transferred to another, non-restricted country will remain fully covered under the original warranty and service offering. <i>Note 1</i> : Terms and conditions may vary by country. Certain restrictions and exclusions apply. For details, consult the Product Information Centre at 1-888-88-COMPAQ. <i>Note 2</i> : On-site service may be provided pursuant to a service contract between Compaq and an authorized Compaq third-party provider, and is not available in certain countries. Global service response times are based on commercially reasonable best effort and may vary by country. <i>Note 3</i> : Technical telephone support applies only to Compaq-configured, Compaq and Compaq-qualified, third-party hardware and software. Toll-free calling and 24 x 7 support may not be available in some countries.
----------------------------	--

---

## After-Market Options

Graphics	NVIDIA GeForce2 MX200 16-MB AGP	251954-B21	
	NVIDIA GeForce2 MX400 32-MB AGP	227003-B21	
	Matrox G200 MMS PCI Quad with DVI Cables	179597-B21	
	Matrox G200 MMS PCI Quad Analog Cables	159513-B21	
	DVI Cables for the G200 MMS PCI Quad	170840-B21	
Hard Drives	<b><i>SMART III Ultra ATA/100 Hard Drives with Drive Protection System (DPS)</i></b>		
	80-GB 7200 rpm SMART III Ultra ATA Quiet Seek and Idle Hard Drive with DPS (worldwide)	250020-B21	
	40-GB 7200 rpm SMART III Ultra ATA Quiet Seek and Idle Hard Drive with DPS (worldwide)	201066-B21	
	20-GB 7200 rpm SMART III Ultra ATA Quiet Seek and Idle Hard Drive with DPS (worldwide)	251974-B21	
	<b><i>SCSI Hard Drives</i></b>		
	72-GB 10K rpm 1-inch Ultra3 (Ultra 160) SCSI Hard Drive	250023-B21	
	36-GB 15K rpm Ultra3 (Ultra 160) SCSI Hard Drive	250022-B21	
	18.2-GB 10K rpm Ultra3 (Ultra 160) SCSI Hard Drive	159764-B21	
	18.2-GB 15K rpm Ultra3 (Ultra 160) SCSI Hard Drive	191188-B21	
	Adaptec 29160N Ultra160 (Ultra3) SCSI Controller	157810-B21	
	*SCSI hard drives are not compatible with Windows 98		
	Input/Output Devices	<b><i>Keyboards</i></b>	
		Compaq Easy Access Keyboard (carbon)	202109-008
<b><i>Mice</i></b>			
Compaq 2-Button Scroll Mouse (PS/2)		170299-B22	
Compaq 2-Button Scroll Mouse (USB)		195255-B25	
Memory (DIMMs)	<b><i>133-MHz SDRAM DIMMs</i></b>		
	512-MB Memory Kit (1 X 512-MB SDRAM DIMM, 133 Mhz)	259039-B21	
	256-MB Memory Kit (1 x 256-MB SDRAM DIMM, 133 MHz)	174225-B21	
	128-MB Memory Kit (1 x 128-MB SDRAM DIMM, 133 MHz)	174224-B21	
	64-MB Memory Kit (1 x 64-MB SDRAM DIMM, 133 MHz)	174223-B21	
Monitors	<b><i>TFTs</i></b>		
	Compaq TFT7020 Monitor (17-inch, Carbon/silver)	253217-001	
	Compaq TFT5030 Monitor (15-inch, Carbon/silver)	228134-001	
	Compaq TFT5015 Monitor (15-inch, Opal)	234043-001	
	Compaq TFT5015 Monitor (15-inch, Carbon/silver)	234044-001	

## After-Market Options

### Monitors (continued)

#### CRTs

##### Professional Series

Compaq P1220 CRT Monitor (21-inch, Carbon/silver)	244374-001
Compaq P1210 CRT Monitor (21-inch, Opal)	210290-001
Compaq P1210 CRT Monitor (21-inch, Carbon/silver)	230538-001
Compaq P920 CRT Monitor (19-inch, Carbon/silver)	244375-001
Compaq P910 CRT Monitor (19-inch, Opal)	210254-001
Compaq P910 CRT Monitor (19-inch, Carbon/silver)	230535-001
Compaq P710 CRT Monitor (17-inch, Opal)	210189-001
Compaq P720 CRT Monitor (17-inch, Carbon/silver)	244373-001

##### Value Series

Compaq V720 CRT Monitor (17-inch, Opal)	232943-001
Compaq V720 CRT Monitor (17-inch, Carbon/silver)	232944-001
Compaq V710 CRT Monitor (17-inch, Opal)	187895-001
Compaq V570 CRT Monitor (15-inch, Opal)	228114-001
Compaq V570 CRT Monitor (15-inch, Carbon/silver)	228113-001

##### Standard Series

Compaq S910 CRT Monitor (19-inch, Opal)	138485-001
Compaq S920 CRT Monitor (19-inch, Opal)	240325-001
Compaq S920 CRT Monitor (19-inch, Carbon/silver)	240326-001
Compaq S720 CRT Monitor (17-inch, Opal)	239286-001
Compaq S720 CRT Monitor (17-inch, Carbon/silver)	239287-001
Compaq S510 CRT Monitor (15-inch, Carbon)	168636-002

### Multimedia

Labtec Spin-22 Speakers (carbon)	246637-001
----------------------------------	------------

### Optical Drives

#### DVD-ROM Drives

16X/40X DVD-ROM Drive (carbon)	237495-B22
--------------------------------	------------

#### DVD-RAM Drives

4.7-GB DVD-RAM Drive (carbon)	294415-B22
-------------------------------	------------

#### CD-ROM Drives

48X Max CD-ROM Drive (carbon)	187217-B22
-------------------------------	------------

#### DVD-RW Drives

4.7-GB DVD-RW Drive (carbon)	246625-B22
4.7-GB DVD-R Media (5-pack)	239405-001
4.7-GB DVD-RW Media	249142-001

#### CD-RW Drives

16X/10X/40X CD-RW Drive	240598-B22
-------------------------	------------

## After-Market Options

---

### Removable Storage

#### *Floppy Drives*

ZIP 100 High-Capacity Floppy Drive (carbon)	294402-B22
ZIP 100 Media 3-Pack	127591-B21
ZIP 250 High-Capacity Floppy Drive (carbon)	294416-B22
ZIP 250 Media 3-Pack	217896-B21

#### *Tape Drives*

TR5 10/20-GB Tape Drive (carbon)	294243-B22
TR5 10/20-GB Media 3-Pack	125782-B21

### Security

USB Biometric Identification Device	240238-B21
Basic Smartcard Keyboard	115506-008

### Communications

#### **NICs**

Intel 10/100S Management Adapter	212953-B21
Intel 10/100S Management Adapter (20-pack)	212954-B21

## Memory

---

845 chipset (128-MB)

### 133-MHz SDRAM DIMM MEMORY

#### STANDARD MEMORY

128-MB DIMM Standard

#### MAXIMUM MEMORY

Intel 845 Chipset supports up to 3-GB of PC133 SDRAM. Platform can utilize 3-GB of memory when 1-GB DIMMs are available with the installation of optional SDRAM Memory Kits.

Memory		Slot		
		1	2	3
Standard	128-MB	128-MB	Empty	Empty
Current Maximum Memory	1.5-GB	512-MB	512-MB	512-MB
Maximum Memory when 1-GB available	3-GB	1-GB	1-GB	1-GB

Note: All Compaq Evo Desktop D500 contain three DIMM slots, but can be upgraded to a maximum of 3-GB when 1-GB DIMMS are available.

Note: It is not necessary to add memory in pairs or kits. Memory upgrades are accomplished by adding single or multiple DIMMs of the same or varied sizes. This chart does not represent all possible memory configurations.

---

845 chipset (256-MB)

### 133-MHz SDRAM DIMM MEMORY

#### STANDARD MEMORY

256-MB DIMM Standard

#### MAXIMUM MEMORY

Intel 845 Chipset supports up to 3-GB of PC133 SDRAM. Platform can utilize 3-GB of memory when 1-GB DIMMs are available with the installation of optional SDRAM Memory Kits.

Memory		Slot		
		1	2	3
Standard	256 MB	256 MB	Empty	Empty
Current Maximum Memory	1.5-GB	512-MB	512-MB	512-MB
Maximum Memory when 1-GB available	3-GB	1-GB	1-GB	1-GB

Note: All Compaq Evo Desktop D500 contain three DIMM slots, but can be upgraded to a maximum of 3-GB when 1-GB DIMMS are available.

Note: It is not necessary to add memory in pairs or kits. Memory upgrades are accomplished by adding single or multiple DIMMs of the same or varied sizes. This chart does not represent all possible memory configurations.

## Storage

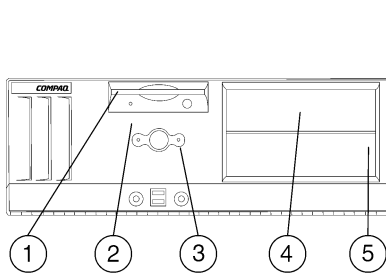

Desktop Configuration

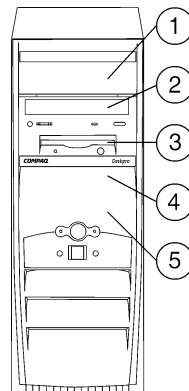

Convertible Minitower Configuration

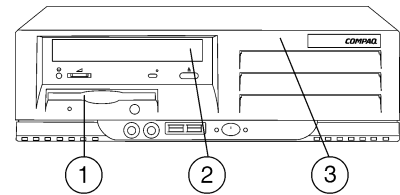

Small Form Factor Configuration

## EVO DESKTOP D500 DRIVE SUPPORT

	Quantity Supported	Position Supported	Controller
<b>DESKTOP</b>			
Diskette Drives	1	1	Floppy
Tape Drives	2	4,5	IDE
CD-ROM Drives	2	4,5	IDE
DVD-ROM Drives	2	4,5	IDE
CD-RW Drives	2	4,5	IDE
SMART III Ultra ATA Hard Drives	Up to 2	2,3	Ultra ATA
SCSI Hard Drives	Up to 2	2,3	SCSI

## CONVERTIBLE MINTOWER

Diskette Drives	1	3	Floppy
Tape Drives	2	1,2	IDE
CD-ROM Drives	2	1,2	IDE
DVD-ROM Drives	2	1,2	IDE
CD-RW Drives	2	1,2	IDE
SMART III Ultra ATA Hard Drives	Up to 2	4,5	Ultra ATA
SCSI Hard Drives	Up to 2	4,5	SCSI

## SMALL FORM FACTOR

Diskette Drives	1	1	Floppy
Tape Drive	1	2	IDE
CD-ROM Drives	1	2	IDE
DVD-ROM Drives	1	2	IDE
SMART III Ultra ATA Hard Drives	1	3	IDE

## Technical Specifications – Audio

Integrated AC97 Audio with internal speaker	<b>Card Type</b>	Integrated
	<b>Plug and Play</b>	Yes
	<b>Stereo Codec</b>	Yes
	<b>OPL3 FM Synthesis</b>	Yes
	<b>Sound Blaster Compatibility</b>	Yes
	<b>Ports</b>	Microphone-in (10-Kohm Minimum) Line-in (10-Kohm Minimum) Headphone/Line-out (16-ohm Minimum)
	<b>Sampling</b>	7 kHz to 48 kHz
	<b>Compression</b>	ADPCM, ESPCM
	<b>OS support</b>	Windows 98 S.E. Windows 2000
	<b>Wavetable Syntheses (software)</b>	Yes

## Technical Specifications – Communications

Integrated Intel PRO/100 VM Network Connection with WOL	<b>Connectors</b>	RJ-45
	<b>Expansion Bus Architecture</b>	PCI 2.2
	<b>Network Transfer Rate</b>	10Base-T (Half-Duplex) 10 Mb/s 10Base-T (Full-Duplex) 20 Mb/s 100Base-TX (Half-Duplex) 100 Mb/s 100Base-TX (Full-Duplex) 200 Mb/s
	<b>Standards Compliance</b>	IEEE 802.3 (10 Mb/s Ethernet) IEEE 802.3u (100 Mb/s Ethernet)
	<b>OS Driver Support</b>	Windows 98 S.E. Windows 2000 SP1
	<b>Remote Wakeup</b>	Yes (WAKE signal)
	<b>Proactive Alert Technology</b>	No
	<b>Environmental Requirements</b>	
	<b>Temperature</b>	Operating 50° to 95°F/10° to 35°C Non-operating -4° to 140°F/-20° to 60°C
	<b>Humidity</b>	Operating 20% to 80% Non-operating 10% to 90%

## Technical Specifications – Communications

<b>3COM 3C920C-TX Network Connection</b>	<b>Manufacturer</b>	3ComOL		
	<b>Connector</b>	RJ-45		
	<b>Expansion bus architecture</b>	PCI 2.2		
	<b>Configuration</b>	Network transfer rate	10BaseT (half-duplex)	10 Mbps
			10BaseT (full-duplex)	20 Mbps
			100BaseTX (half-duplex)	100 Mbps
			100BaseTX (full-duplex)	200 Mbps
		Data interface	PCI, 32-bit bus mastering	
	I/O address	Automatic I/O address		
	Interrupt level	Automatic IRQ setup		
	<b>Standards compliance</b>	IEEE 802.3 (10-Mbps Ethernet), IEEE 802.3u (100-Mbps Ethernet)		
	<b>OS driver support</b>	Microsoft Windows 95, Microsoft Windows 98, Microsoft Windows 2000, Microsoft Windows NT 3.5/x and 4.0		
	<b>Remote wakeup</b>	Yes, WAKE signal		
	<b>Proactive alert technology</b>	No		
	<b>Environmental operating requirements</b>	Temperature	32° to 131° F (0° to 55° C)	
Humidity (non-condensing)		10% to 90%		
<b>Power management</b>	ACPI			
<b>Network management</b>	DMI 2.0, WfM 2.x, PCI 2.2			
<b>Power</b>	+3.3 V, 340 mA			
<b>LED indicators</b>	100-Mbps link, 10-Mbps link, activity			
<b>Dimensions</b>	4.7 x 2.2 in/12.0 x 5.6 cm			
<b>Certifications</b>	CE Mark, FCC Class B, VCCI Class B, CISPR 22 Class B			

## Technical Specifications – Communications

Lucent V.90 56K PCI Win Modem	<b>Data Transmission</b>	V.90/K56flex technology speeds: 56,000 Kb/s maximum downstream data; controllerless
	<b>Data Speeds</b>	(upload only): 33,600; 31,200; 28,800; 26,400; 21,600; 19,200; 16,800; 14,400; 12,000; 9600; 7200; 4800; 2400; and 300 b/s
	<b>Data Standards</b>	ITU V.90, ITU-T, V.34, V.32 (bis), V.22bis, V.22, V.21, V.23, and Bell 212A, and Bell 103.
	<b>Fax speeds</b>	14400; 12000; 9600; 7200; 4800; 2400; 1200; 300 b/s
	<b>Fax mode capabilities</b>	Group 3 FAX: V.17, V.29, V.27ter, and V21 Channel 2., Class 1 interface, TIA/EIA-578
	<b>Error Correction and Data Compression</b>	ITU-T recommended V.42 error correction, V.42 error correction (LAPM and MNP), V.42bis and MNP Class 5 data compression, ITU-T V.42bis data compression
	<b>Power Management</b>	APM and ACPI states D0, D1, D2, and D3, Meets PCI 2.2 requirements and PC 99 requirements
	<b>Upgradability</b>	Software driver upgradable for future enhancements
	<b>Video</b>	ITU-T V.80 video ready interface
	<b>Other</b>	TIA/EIA 602 standard AT command set Built-in DTE interface with speeds up to 115.2 Kb/s, parallel 16550a UART-compatible interface Optional Ring wake signal
	<b>Operating temperature</b>	32° to 104° F/0° to 40° C
	<b>Operating humidity</b>	20% to 80%, non-condensing
	<b>Operating System Driver Support</b>	Microsoft Windows 98, 98SE, NT4.0, Windows 2000
	<b>Warranty</b>	Product takes on the warranty of the Desktop in which they are installed. <a href="#">Note: Certain restrictions and exclusions apply. For details, consult the Product Information Centre at 1-888-88-COMPAQ.</a>

## Technical Specifications – Graphics

NVIDIA Vanta16-MB AGP Graphics Controller	<b>Form factor</b>	Half-size ATX
	<b>Bus type</b>	AGP 4X
	<b>Memory support</b>	16-MB SDRAM (64-bit frame buffer interface)
	<b>Memory clock</b>	125 MHz
	<b>RAMDAC</b>	250 MHz
	<b>Internal clock</b>	100 MHz
	<b>Data path</b>	64-bit
	<b>Process</b>	0.22µ
	<b>Pipelines</b>	2 (bilinear)
	<b>Fill rate</b>	200 M pixels per second
	<b>Triangle rate</b>	8 M triangles per second
	<b>Video overlay filter</b>	2 x 2
	<b>MPEG support (software)</b>	CSC IDCT
	<b>Colour space conversion</b>	Yes
	<b>Scaling</b>	Yes
	<b>Quick draw support</b>	Yes
	<b>DCI and Microsoft DirectX video playback</b>	Yes
	<b>Microsoft DirectX support</b>	Yes
	<b>3-D support</b>	Yes
	<b>Engine acceleration</b>	Basic video colour conversion and scaling 100% hardware triangle setup engine
	<b>Dual monitor support</b>	With additional PCI controller only
	<b>OS support</b>	Microsoft Windows 98, Microsoft Windows 2000, Microsoft Windows NT 4.0, Microsoft Windows Me
	<b>Other</b>	Optimized for Direct3D acceleration with support for Microsoft DirectX 5.0 and 6.0 128-bit Twin-Texel (TNT) architecture Two texture-mapped, lit pixels per clock Single pass multi-texture rendering 32-bit rendering with destination alpha 24-bit Z-buffer, 8-bit stencil buffer Anisotropic filtering (superior to trilinear MIP-mapping) High-performance, 128-bit 2-D/GUI/DirectDraw acceleration Transparent BLT, stretch BLT, points, lines, polylines, polygons, fills, patterns, arbitrary clipping and fast text rendering; pipeline optimized for multiple colour depths including 8, 16, and 24 bits per pixel Video acceleration for DirectShow, MPEG-1, MPEG-2 and Intel Indeo® Fast 32-bit VGA/SVGA Triple 8-bit, 250-MHz palette DAC

Resolutions Supported	Colours	Real-Time 3-D Gouraud Shading	Refresh Rates
1920 x 1200	256, 65K, 16.7M	256, 65K	60 to 75 Hz depending on colour depth
1920 x 1080	256, 65K, 16.7M	256	60 to 85 Hz depending on colour depth
1600 x 1200	256, 65K, 16.7M	256	60 to 85 Hz depending on OS and colour depth
1280 x 1024	256, 65K, 16.7M	256, 65K	60 to 100 Hz
1152 x 864	256, 65K, 16.7M	256, 65K	60 to 85 Hz depending on colour depth
1024 x 768	256, 65K, 16.7M	256, 65K, 16.7M	60 to 85 Hz
800 x 600	256, 65K, 16.7M	256, 65K, 16.7M	60 to 85 Hz
640 x 480	256, 65K, 16.7M	256, 65K, 16.7M	60 to 85 Hz

## Technical Specifications – Graphics

NVIDIA GeForce2 MX 16- and 32-MB Graphics Controllers	<b>Vertical frequency</b>	60-85 Hz
	<b>Graphics controller</b>	NVIDIA GeForce2 MX 200 and 400
	<b>Bus type</b>	AGP 4X
	<b>RAMDAC</b>	Integrated 350 MHz RAMDAC
	<b>Memory type</b>	SDRAM
	<b>Memory amount</b>	16, 32 (64-MB unified frame buffer and texture memory, 16-MB on GeForce2 MX 200)
	<b>Memory speed</b>	166 MHz
	<b>Data path</b>	256-bit
	<b>Controller clock speed</b>	GeForce2 MX 200—175 MHz GeForce2 MX 400—200 MHz
	<b>Maximum vertical refresh rate</b>	85-Hz
	<b>Maximum pixel clock</b>	350-MHz
	<b>Graphics API support</b>	DirectX 7, DirectX 8
	<b>Operating systems support</b>	Microsoft Windows 2000, Microsoft Windows NT 4.0, and Microsoft Windows 98
	<b>Buffer</b>	96-bit (per pixel)
	<b>Image planes</b>	24-bit double-buffered
	<b>Z-buffer</b>	32-bit (24-bit with stencil planes)
	<b>Overlay</b>	Supported
<b>Stencil planes</b>	8-bit (maximum)	
<b>Alpha planes</b>	8-bit	
<b>External interface</b>	Analog video output port; the video port (female, 15-pin, D-SUB connector) provides connection to an analog display	

### Resolutions Supported

Resolution	Refresh Rate (Hz)		Max Refresh Rate (Hz)
	8-bit Colour	16-bit Colour	32-bit Colour
1920 x 1440	85, 75	85, 75	85, 75
1920 x 1200	85	85	85
1920 x 1080	85	85	85
1600 x 1200	85	85	85
1280 x 1024	85	85	85
1152 x 864	85	85	85
1024 x 768	85	85	85
800 x 600	85	85	85
640 x 480	85	85	85

## Technical Specifications – Graphics

Matrox Millennium G450 Dual Head AGP and PCI Graphics Controllers	<b>Form Factor</b>	ATX		
	<b>Bus type</b>	AGP 1X, 2X, 4X: PCI Rev 2.2 bus specification		
	<b>Standard memory</b>	AGP: 32 MB/PCI: 16 MB		
	<b>DAC speed</b>	360 MHz (secondary DAC: 200 MHz)		
	<b>Data path</b>	64-bit DDR External/256-bit Internal		
	<b>Internal bus width</b>	256-bit DualBus		
	<b>Memory interface</b>	64-bit DDR Memory		
	<b>Frame buffer</b>	AGP: 32 MB/PCI: 16 MB		
	<b>Two integrated RAMDACs</b>	Yes		
	<b>Engine acceleration</b>	3 ROP bitBLT, line draw, text, colour expansion, basic video colour conversion and scaling, triangle setup engine		
	<b>Other</b>	PCI bus mastering, texture mapping support, flat and Gouraud shading, direct 3-D support, Anisotropic Filter, perspective texture, specular highlighting, wireframe, dithering, full scene anti-aliasing, vertex fog, dual texture mapping, Plug-and-Play AGP 2X and AGP 4X, 0.18-micron technology (lower heat/power consumption), high-quality DVD playback with full access to Microsoft Windows, Colour Space Conversion, Quick Draw support, DCI and DirectX video playback, MS DirectDraw support		
	<b>3D Features</b>	Single cycle multi-texturing	Yes	
		Environment-mapped bump mapping	Yes	
		Internal rendering	32-bit	
		Source textures	Up to 32-bit	
		Maximum texture size	2048 X 2048	
		Hardware non-power-of- 2 textures	Yes	
		32-bit colour output	Yes	
		32-bit independent Z-buffer	Yes	
		Stencil buffering	Yes	
		AGP texturing	Yes	
		Trilinear filtering	Yes	
		DirectX support	Yes	
OpenGL support		Yes		
<b>DualHead Display Features</b>	Multi-Display Mode, DVD Max Mode, DualHead Zoom Mode, DualHead Clone Mode, Single Chip Multi-Monitor support			
<b>Supported Modes</b>	This list assumes setup to be DualHead multi-display running Microsoft Windows 98. If using Microsoft Windows NT 4.0 or Microsoft Windows 2000 while in multi-display, primary CRT is limited to modes supported by 2nd CRT.			
<b>Primary CRT Colour Depths</b>	<b>Colour Depths (bpp)</b>	<b>Refresh Rates</b>		
640 x 480	8, 16, 24, 32	60 Hz, 72 Hz, 75 Hz, 85 Hz		
800 x 600	8, 16, 24, 32	60 Hz, 72 Hz, 75 Hz, 85 Hz		
1024 x 768	8, 16, 24, 32	60 Hz, 70 Hz, 75 Hz, 85 Hz		
1152 x 864	8, 16, 24, 32	75 Hz		
1280 x 960	8, 16, 24, 32	60 Hz, 75 Hz, 85 Hz		
1280 x 1024	8, 16, 24, 32	60 Hz, 75 Hz, 85 Hz		
1600 x 1200	8, 16, 24, 32	60 Hz, 65 Hz, 70 Hz, 75 Hz (85 Hz available in single monitor configuration only)		
1800 x 1440	8, 16, 24	60 Hz, 72 Hz, 75 Hz, 85 Hz		
1856 x 1392	8, 16, 24	60 Hz, 75 Hz, 85 Hz		
1920 x 1440	8, 16, 24	60 Hz, 75 Hz, 85 Hz		
2048 x 768	8, 16	60 Hz, 75 Hz		
<b>Secondary CRT Colour Depths</b>	<b>Colour Depths (bpp)</b>	<b>Refresh Rates</b>		
640 x 480	16, 32	60 Hz, 72 Hz, 75 Hz, 85 Hz		
800 x 600	16, 32	60 Hz, 72 Hz, 75 Hz, 85 Hz		
1024 x 768	16, 32	60 Hz, 70 Hz, 75 Hz, 85 Hz		
1152 x 864	16, 32	75 Hz		
1280 x 960	16, 32	60 Hz, 75 Hz, 85 Hz		
1280 x 1024	16, 32	60 Hz, 75 Hz, 85 Hz		
1600 x 1200	16, 32	60 Hz, 65 Hz, 70 Hz, 75 Hz, 85 Hz		

## Technical Specifications – Graphics

Matrox G200 MMS Quad Head 32-MB PCI Graphics Controller	<b>Interface</b>	PCI		
	<b>Standard Memory</b>	32MB SGRAM (8MB per port)		
	<b>DAC Speed</b>	250MHz		
	<b>Data Path</b>	128-bit Internal/64-bit External		
	<b>Colour Space Conversion</b>	Yes		
	<b>Scaling</b>	Yes		
	<b>Quick Draw Support</b>	Yes		
	<b>DCI and DirectX Video Playback</b>	Yes		
	<b>Direct3D Support</b>	Yes		
	<b>Engine Acceleration</b>	3 ROP bitBLT		
		Line Draw		
		Text		
		Colour Expansion		
		Basic Video Colour Conversion and Scaling		
<b>Output</b>	The Matrox G200 Quad MMS controller features two output ports, which require 2 adapter cables to connect analog or digital output displays			
	Analog Display Support	2 RGB cables support two DB-15 analog displays per cable		
	DVI (Digital Visual Interface)	DVI cable option kit provides two DVI cables for connecting two DVI compliant displays per cable		
	Display Support	Display options supported	Four analog displays via two RGB cables	
			Four DVI displays via two DVI cables	
		Two analog displays via one RGB cable and two DVI displays via one DVI cable		
<b>OS Support</b>	Windows NT 4.0			
<b>Other</b>	PCI bus mastering			
	Texture mapping support			
	Flat and Gouraud shading			
	Anisotropic Filter			
	Perspective texture			
	Specular highlighting			
	Dithering			
	Full scene anti-aliasing			
	Vertex fog			

## Technical Specifications – Graphics

Matrox G200 MMS Quad Head 32-MB PCI Graphics Controller ( <i>continued</i> )	Refresh Rate (per display)			
	Aspect Ratio	Resolution	Vertical	Horizontal
4:3/5:4		640 x 480	60-200Hz	31-102KHz
		800 x 600	60-200Hz	38-114KHz
		1024 x 768	60-140Hz	48-113KHz
		1152 x 864	60-120Hz	54-110KHz
		1280 x 1024	60-100Hz	64-107KHz
		1600 x 1200	60-90Hz	75-113KHz
16:9/16:10		1800 x 1440	60-70Hz	89-104KHz
		856 x 480	60-200Hz	30-108KHz
		1280 x 720	60-100Hz	44-76KHz
		1600 x 1024	60-100Hz	64-108KHz
		1920 x 1080	60-80Hz	70-94KHz
		1920 x 1200	60-76Hz	75-95KHz

With DVI digital flat panel displays, the maximum display resolution is 1280 x 1024

Maximum refresh rates may not be attainable at the highest display resolutions with 24 or 32-bit colour palettes

## Technical Specifications – Hard Drives

---

7200 rpm SMART III Ultra ATA/100 Hard Drives	60 GB	<b>Capacity</b>	60,000 MB	
		<b>Rotational Speed</b>	7200 rpm	
		<b>Interface</b>	Ultra ATA/100	
		<b>Height</b>	1 in/25.4 mm	
		<b>Width</b>	3.5 in/88.9 mm	
		<b>Transfer Rate</b> Synchronous (Maximum)	100 MB/s	
		<b>Seek Time</b> (typical reads, including settling)	Single Track	1.2 ms (2.7 ms quiet seek)
			Average	8 ms (10.1 ms quiet seek)
			Full-Stroke	18 ms (21.1 ms quiet seek)
		<b>Physical Configuration</b>	Logical Blocks	78,165,360
	<b>Operating Temperature</b>	41° to 131°F/5° to 55°C		

Note: 60-GB capacity points include Quiet Idle technology, which reduces acoustic levels approximately 5 decibels, and ship worldwide.

---

40 GB	<b>Capacity</b>	40,000 MB	
	<b>Rotational Speed</b>	7200 rpm	
	<b>Interface</b>	Ultra ATA/100	
	<b>Height</b>	1 in/25.4 mm	
	<b>Width</b>	3.5 in/88.9 mm	
	<b>Transfer Rate</b> Synchronous (Maximum)	100 MB/s	
	<b>Seek Time</b> (typical reads, including settling)	Single Track	1.2 ms (2.7 ms quiet seek)
		Average	8 ms (10.1 ms quiet seek)
		Full-Stroke	18 ms (21.1 ms quiet seek)
	<b>Physical Configuration</b>	Logical Blocks	78,165,360
<b>Operating Temperature</b>	41° to 131°F/5° to 55°C		

Note: 40-GB capacity points include Quiet Idle technology, which reduces acoustic levels approximately 5 decibels, and ship worldwide.

---

20 GB	<b>Capacity</b>	20,000 MB	
	<b>Rotational Speed</b>	7200 rpm	
	<b>Interface</b>	Ultra ATA/100	
	<b>Height</b>	1 in/25.4 mm	
	<b>Width</b>	3.5 in/88.9 mm	
	<b>Transfer Rate</b> Synchronous (Maximum)	100 MB/s	
	<b>Seek Time</b> (typical reads, including settling)	Single Track	1.2 ms (2.7 ms quiet seek)
		Average	8 ms (10.1 ms quiet seek)
		Full-Stroke	18 ms (21.1 ms quiet seek)
	<b>Physical Configuration</b>	Logical Blocks	39,102,336
<b>Operating Temperature</b>	41° to 131°F/5° to 55°C		

Note: 20-GB 7200rpm drives shipping in EMEA with Quiet Seek also have Quiet Idle technology, which reduces acoustic levels by approximately 5 decibels.

---

## Technical Specifications – Hard Drives

---

10,000 rpm Wide Ultra3 SCSI Hard Drives	36.4-GB	<b>Capacity</b>	36,400 MB	
		<b>Rotational Speed</b>	10,000 rpm	
		<b>Height</b>	1 in/25.4 mm	
		<b>Width</b>	3.5 in/88.9 mm	
		<b>Interface</b>	Ultra3 (Ultra160) SCSI	
		<b>Transfer Rate</b> Synchronous (Maximum)	160 MB/s	
		<b>Seek Time</b> (typical reads, including settling)	Single Track	0.6 ms
			Average	4.7 ms
			Full-Stroke	12 ms
		<b>Logical Blocks</b>	71,132,000	
<b>Operating Temperature</b>	50° to 95°F/10° to 35°C			

---

## Technical Specifications – Input/Output Devices

<b>Compaq Easy Access Keyboard</b>	<b>Dimensions (HxWxD)</b>	18.3 x 6.3 x 1.4 in/465 x 160 x 36 mm		
	<b>Weight</b>	Approximately 2 lb/0.9 kg		
	<b>Electrical</b>	Operating Voltage	+5VDC ± 5%	
		Power Consumption	50 mA maximum (with 3 LEDs on)	
		System Interface	PS/2 mini-din connector	
		ESD	CE level 4, 15 kV air discharge	
		EMI-RFI	Conforms to FCC rules for a Class B computing device	
		PC98	Functionally compliant	
		<b>Mechanical</b>	Languages	30+ available
	Keycaps		Low-profile design	
	Switch Actuation		55 g nominal peak force with tactile feedback	
	Switch Life		20 million keystrokes (using Hasco modified tester)	
	Switch Type		Contamination resistant membrane	
	Key Leveling Mechanism		For all double wide and greater length keys	
	Cable Length		6 ft/1.8 m	
	PC98-99		Mechanically compliant	
	Acoustics		50 dBA maximum sound pressure level	
	<b>Environmental</b>		Operating Temperature	50° to 122° F/10° to 50° C
		Non-operating Temperature	-22° to 140° F/-30° to 60° C	
		Operating Humidity	10% to 90% (non condensing at ambient)	
Non-operating Humidity		20% to 80% (non condensing at ambient)		
Operating Shock		40 g, 6 surfaces		
Non-operating Shock		80 g, 6 surfaces		
	Operating Vibration	2 g peak acceleration		
	Non-operating Vibration	4 g peak acceleration		

## Technical Specifications – Input/Output Devices

<b>Compaq Standard Keyboard</b>	<b>Dimensions (HxWxD)</b>	18.3 x 6.3 x 1.4 in/465 x 160 x 36 mm
	<b>Weight</b>	Approximately 2 lb/0.9 kg
<b>Electrical</b>	<b>Operating Voltage</b>	+ 5VDC ± 5%
	<b>Power Consumption</b>	50 mA maximum (with 3 LEDs on)
	<b>System Interface</b>	PS/2 mini-din connector
	<b>ESD</b>	CE level 4, 15kV air discharge
	<b>EMI-RFI</b>	Conforms to FCC rules for a Class B computing device
	<b>PC98</b>	Functionally compliant
<b>Mechanical</b>	<b>Languages</b>	30+ available
	<b>Keycaps</b>	Low-profile design
	<b>Switch Actuation</b>	55 gram nominal peak force with tactile feedback
	<b>Switch Life</b>	20 million keystrokes (using Hasco modified tester)
	<b>Switch Type</b>	Contamination resistant membrane
	<b>Key Leveling Mechanism</b>	For all double wide and greater length keys
	<b>Cable Length</b>	6 in/1.8 m
	<b>PC98-99</b>	Mechanically compliant
	<b>Acoustics</b>	50 dBA maximum sound pressure level
	<b>Environmental</b>	<b>Operating Temperature</b>
<b>Non-operating Temperature</b>		-22° to 140° F/-30° to 60° C
<b>Operating Humidity</b>		10% to 90% (non condensing at ambient)
<b>Non-operating Humidity</b>		20% to 80% (non condensing at ambient)
<b>Operating Shock</b>		40 g, 6 surfaces
<b>Non-operating Shock</b>		80 g, 6 surfaces
	<b>Operating Vibration</b>	2 g peak acceleration
	<b>Non-operating Vibration</b>	4 g peak acceleration

## Technical Specifications – Input/Output Devices

<b>Compaq 2-Button Scroll Mouse</b>	<b>Scroll Wheel</b>	8 mm		
	<b>Maximum Rotation Speed</b>	30 mm/s		
	<b>Switch Type</b>	Light force micro-switch		
	<b>Switch Life</b>	1 million operations		
	<b>Mechanical Life</b>	Minimum 200,000 revolutions		
	<b>Environmental</b>	Operating Temperature	50° to 122° F/10° to 50° C	
		Non-operating Temperature	-22° to 140° F/-30° to 60° C	
		Operating Humidity	10% to 90% (non condensing at ambient)	
		Non-operating Humidity	20% to 80% (non condensing at ambient)	
		Operating Shock	40 g, 6 surfaces	
		Non-operating Shock	80 g, 6 surfaces	
		Operating Vibration	2 g peak acceleration	
		Non-operating Vibration	4 g peak acceleration	
		<b>Electrical</b>	Operating Voltage	+5VDC ± 10%
			Power Consumption	15mA
	System Consumption		PS/2 mini-din connector	
	ESD		CE level 4, 15 kV air discharge	
	EMI-RFI		Conforms to FCC rules for a Class B computing device	
	PC98		Functionally compliant	
	<b>Mechanical</b>		Resolution	400 ± 20% DPI
		Tracking Speed	10 in/s maximum	
		Acceleration	100 in/s	
		Switch Actuation	85 g nominal peak force	
		Switch Life	1,000,000 operations (using Hasco modified tester)	
		Cable Length	2 m	
		PC98-99	Mechanically compliant	
	<b>Regulatory Approvals</b>	UL, CSA, FCC, CE Mark, TUV, TUV GS, VCCI, BCIQ, C-Tick		

## Technical Specifications – Optical Storage

48X CD-ROM Drive	<b>Interface</b>	ATAPI IDE
	<b>Data buffer</b>	16.6 Mbps
	<b>Data transfer rate</b>	Sustained—150 Kbps minimum (audio)      Variable (CD)—3,000 to 7,200 Kbps
	<b>Disk rotation technology</b>	CAV (Constant Angular Velocity)
	<b>Access time (ms)</b>	Random: <100 ms      Full-stroke seek: <150 ms
	<b>Average access time</b>	< 80 ms
	<b>Cache buffer (standard/maximum)</b>	128 KB
	<b>Disk formats read</b>	Multi-session Photo CD, multi-read CD-ROM, CD text, audio CD, CD-I, CD-RW, CD-R, CD-Extra, CD-ROM XA
	<b>Disk formats written</b>	None
	<b>Disk capacity (CD)</b>	650 MB
	<b>Block size</b>	Mode 1—2,048 bytes Mode 2—2,340/2,336 bytes CD-DA—2,352 bytes CD-XA—2,328 bytes
	<b>Diameter</b>	12 cm; 8 cm
	<b>Thickness</b>	1.2 mm
	<b>Track pitch</b>	1.6 µm
	<b>Audio output level</b>	Line-out—0.7 V @ 47 Kohm      Headphone—0.6 V @ 32 ohm
	<b>Startup time</b>	<7 seconds (typical); < 30 seconds with multi-session
	<b>Operating conditions</b>	Temperature      41° to 113° F (5° to 45° C) Relative humidity      10% to 80%
	<b>Dimensions (HxWxD, maximum)</b>	1.7 x 5.9 x 8.2 in/4.3 x 15.0 x 20.8 cm
	<b>Weight</b>	2.6 lb (1200 g)
	<b>Operating systems supported</b>	Microsoft Windows 98/98SE, Microsoft Windows 2000, and Microsoft Windows NT 4.0 SP4 or later
	<b>MPEG playback graphics solution support</b>	None
	<b>Kit contents</b>	CD-ROM drive, driver diskette, IDE cable, installation guide, warranty card Note: Certain restrictions and exclusions apply. For details, consult the Product Information Centre at 1-888-88-COMPAQ.

## Technical Specifications – Optical Storage

<b>16X/10X/40X CD-RW Drive</b>	<b>Interface</b>	ATAPI IDE												
	<b>Media formats written</b>	CD-R and CD-RW												
	<b>Media capacity</b>	650 MB												
	<b>Write methods</b>	Disc-at-once, track-at-once, session-at-once, fixed packet, and variable packet												
	<b>Recording/playing time</b>	74 minutes												
	<b>Data transfer rates</b>	<table border="0"> <tr> <td>Sustained</td> <td>CD-R write—2,400 Kbps (16X)</td> </tr> <tr> <td></td> <td>CD-RW write (1-4X media) —1,500 Kbps (4X)</td> </tr> <tr> <td></td> <td>CD-RW write (4-10X media) —1,500 Kbps (10X)</td> </tr> <tr> <td></td> <td>CD-RW read—1,500 Kbps (10X)</td> </tr> <tr> <td></td> <td>Digital audio extraction (minimum) —1,500 Kbps (10X)</td> </tr> <tr> <td>Variable</td> <td>CD-ROM, CD-R read—1,500 to 6,000 Kbps (10X to 40X)</td> </tr> </table>	Sustained	CD-R write—2,400 Kbps (16X)		CD-RW write (1-4X media) —1,500 Kbps (4X)		CD-RW write (4-10X media) —1,500 Kbps (10X)		CD-RW read—1,500 Kbps (10X)		Digital audio extraction (minimum) —1,500 Kbps (10X)	Variable	CD-ROM, CD-R read—1,500 to 6,000 Kbps (10X to 40X)
Sustained	CD-R write—2,400 Kbps (16X)													
	CD-RW write (1-4X media) —1,500 Kbps (4X)													
	CD-RW write (4-10X media) —1,500 Kbps (10X)													
	CD-RW read—1,500 Kbps (10X)													
	Digital audio extraction (minimum) —1,500 Kbps (10X)													
Variable	CD-ROM, CD-R read—1,500 to 6,000 Kbps (10X to 40X)													
	<b>Data transfer modes</b>	ATA PIO mode 4—16.7 Mbps ATA multi-word DMA mode 2—16.7 Mbps ATA UltraDMA mode 0—16.7 Mbps (mandatory and default setting) ATA UltraDMA mode 1—24 Mbps (optional); mode 2—33 Mbps (optional)												
	<b>Media formats read</b>	CD-audio, CD-ROM (modes 1 and 2), CD-ROM XA (mode 2, forms 1 and 2), single- or multi-session photo CD, CD-I, video CD, CD-text												
	<b>Access times</b>	<table border="0"> <tr> <td>Random</td> <td>&lt;120 ms typical</td> </tr> <tr> <td>Full stroke</td> <td>&lt;200 ms typical</td> </tr> </table>	Random	<120 ms typical	Full stroke	<200 ms typical								
Random	<120 ms typical													
Full stroke	<200 ms typical													
	<b>Rotational speed</b>	<table border="0"> <tr> <td>17X—40X CAV</td> <td>8,350 RPM, constant</td> </tr> <tr> <td>16X CLV</td> <td>3,424—7,952 RPM</td> </tr> <tr> <td>10X CLV</td> <td>2,140—4,970 RPM</td> </tr> <tr> <td>8X CLV</td> <td>1,712—3,976 RPM</td> </tr> <tr> <td>4X CLV</td> <td>856—1,988 RPM</td> </tr> </table>	17X—40X CAV	8,350 RPM, constant	16X CLV	3,424—7,952 RPM	10X CLV	2,140—4,970 RPM	8X CLV	1,712—3,976 RPM	4X CLV	856—1,988 RPM		
17X—40X CAV	8,350 RPM, constant													
16X CLV	3,424—7,952 RPM													
10X CLV	2,140—4,970 RPM													
8X CLV	1,712—3,976 RPM													
4X CLV	856—1,988 RPM													
	<b>Start-up time</b>	<table border="0"> <tr> <td>Single</td> <td>&lt;7 seconds typical</td> </tr> <tr> <td>Multi-session</td> <td>&lt;30 seconds typical</td> </tr> </table>	Single	<7 seconds typical	Multi-session	<30 seconds typical								
Single	<7 seconds typical													
Multi-session	<30 seconds typical													
	<b>Stop time</b>	<4 seconds												
	<b>Block size</b>	Mode 1—2,048/2,352 bytes Mode 2, Form 1—2,048/2,328/2,336/2,340/ 2,352 bytes Mode 2, Form 2—2,328/2,336/2,340/2,352 bytes CD-DA—2,352/2,368 bytes												
	<b>Disc diameter</b>	120 mm or 80 mm												
	<b>Track pitch</b>	1.6 µm												
	<b>Disc loading mechanism</b>	Half-height, tray load												
	<b>Operating conditions</b>	<table border="0"> <tr> <td>Temperature</td> <td>41° to 113° F (5° to 45° C) operating; -4° to 140° F</td> </tr> <tr> <td>Humidity</td> <td>10% to 80%</td> </tr> </table>	Temperature	41° to 113° F (5° to 45° C) operating; -4° to 140° F	Humidity	10% to 80%								
Temperature	41° to 113° F (5° to 45° C) operating; -4° to 140° F													
Humidity	10% to 80%													
	<b>Mounting orientation</b>	Horizontal or vertical												
	<b>Dimensions</b>	Fits in a standard 5.25-inch drive bay												
	<b>Weight</b>	2.6 lb (1.2 kg)												
	<b>Approvals/environmental</b>	UL 94 and 1950, CSA, CE, FDA, FCC												
	<b>Operating systems supported</b>	Microsoft Windows 98, Microsoft Windows NT 4.0, Microsoft Windows 2000												
	<b>Kit contents</b>	16X CD-R media, CD-RW high-speed media, Roxio™ EasyCD Creator Version 4.05, Dantz Retrospect Express Version 5.5 for CD-RW, IDE cable, audio cable												

## Technical Specifications – Optical Storage

16X/40X DVD-ROM Drive with RAM Read	<b>Bus</b>	Ultra DMA 33	
	<b>Data transfer rate</b> (1 KB = 1024 bytes)	Sustained	DVD = 8.1 Mbps to 21.6 Mbps CD-ROM = 2.55 Kbps to 6.00 Kbps
	<b>Disc rotation technology</b>	DVD—CAV (Constant Angular Velocity) CD—CAV	
	<b>Access time</b> (ms)	Random	DVD = <100 ms; CD-ROM = < 80 ms
		Full stroke seek	DVD = <240 ms; CD-ROM = <160 ms
	<b>Cache buffer standard/max</b>	512 KB	
	<b>ATAPI interface</b>	ATAPI	
	<b>Disc formats read</b>	DVD-RAM, DVD-ROM, DVD-video, DVD-R, DVD-RW, DVD-RAM, Photo CD/multi-session, CD-ROM, CD text, audio CD, CD-I, CD-RW, CD-R, CD-DA, video CD, CD Extra, CD-ROM XA, MPEG, MPC level	
	<b>Disc formats written</b>	None	
	<b>Disc</b>	Capacity	CD—650 MB DVD—4.7 GB
		Block size	Mode 0—2,352 (bytes) Mode 1—2,352/2,340/2,336/2,048 (bytes) Mode 2—2,352/2,340/2,336/2,048 (bytes) DVD—2,048 (bytes)
		Diameter	12 cm, 8 cm
		Thickness	1.2 mm (CD-ROM) 1.2 mm (DVD)
		Track pitch	1.6 µm (CD-ROM) 0.74 µm (DVD)
	<b>Audio output level</b>	Line out	0.7± 0.1 Vrms
		Headphones	0.45 ± 0.2 Vrms
	<b>Operating conditions</b>	Temperature	41° to 113° F (5° to 45° C)
		Humidity	5% to 85% relative humidity
	<b>Dimensions</b> (HxWxD)	1.67 x 5.83 x 8.18 in/4.23 x 14.81 x 20.75 cm	
	<b>Weight</b>	2.22 lb (1 kg)	
	<b>Agency approvals/environmentals</b>	UL, CSA, TUV, FDA, FCC, CE, EMI	
	<b>OS support</b>	Microsoft Windows 98/98SE, Microsoft Windows Me, Microsoft Windows 2000, and Microsoft Windows NT 4.0 <i>Note: MPEG video playback is not supported on Microsoft Windows NT.</i>	
	<b>MPEG video playback compatibility</b>	Refer to the platform for support	
	<b>RPC2</b> (Regional Protection Control)	Yes	
	<b>Minimum CPU supported</b>	Intel Pentium II 400 MHz or Intel Celeron™ 466 MHz	
	<b>Mounting orientation</b>	Operates in horizontal or vertical position	
	<b>Kit contents</b>	DVD-ROM drive, MPEG playback software, ReadDVD™ software, IDE cable, audio cable, installation instructions, and warranty card <i>Note: Certain restrictions and exclusions apply. For details, consult the Product Information Centre at 1-888-88-COMPAQ.</i>	

## Technical Specifications – Removable Storage

<b>1.44-MB Diskette Drive</b>	<b>Diskette Size</b>	3.5 in.		
	<b>LED Indicators (front panel)</b>	Green		
	<b>Read/Write Capacity per diskette (high/low density)</b>	1.44 MB/720 KB		
	<b>Drive Supported</b>	One		
	<b>Drive Height</b>	One-third		
	<b>Drive Rotation</b>	300 rpm		
	<b>Transfer Rate (high/low)</b>	500/250 Kb/s		
	<b>Bytes/Sector</b>	512		
	<b>Sectors/Track (high/low)</b>	18/9		
	<b>Tracks/Side (high/low)</b>	80/80		
	<b>Access Times</b>	<b>Track-to-Track (high/low)</b>	3/6 ms	
		<b>Average (high/low)</b>	169/94 ms	
		<b>Settling Time</b>	15 ms	
<b>Latency Average</b>		100 ms		

<b>Zip 250 Drive</b>	<b>Interface</b>	ATAPI IDE		
	<b>Media format supported</b>	Zip disk		
	<b>Media capacity</b>	250 MB		
	<b>Access time</b>	29 ms (average)		
	<b>Drive rotational speed</b>	2,941 rpm		
	<b>Size</b>	Fits into a 5.25-inch bay (with bracket)		
	<b>Data transfer rate</b>	Maximum sustained	2.4 Mbps	
			1.4 Mbps	
			1.4 Mbps (100 MB), 2.4 MB/s (250 MB)	
			0.3 Mbps (100 MB), 2.4 MB/s (250 MB)	
			11.1 Mbps	
	<b>Operating conditions</b>	<b>Temperature</b>	50° to 125° F (10° to 51.5° C)	
		<b>Humidity</b>	20% to 80%	
<b>Compatible operating system</b>	Microsoft Windows 98/98SE, Microsoft Windows 2000, and Microsoft Windows NT 4.0 SP4 or later			
<b>Kit contents</b>	Zip 100 or Zip 250 drive, IDE cable, installation guide, RTF card if needed			
	Note: Enhanced driver support for the operating systems listed above, as well as drivers that support other operating systems can be downloaded at the Iomega Web site: <a href="http://www.iomega.com/www.iomega.com">http://www.iomega.com/www.iomega.com</a> . Note: This Web site is available in English only.			

### Compaq PCs use genuine Microsoft® Windows®

<http://www.Microsoft.com/piracy/howtotell>

© 2002 Compaq Canada Corporation. All rights reserved. Printed in Canada.

Compaq, the Compaq logo and Evo are registered United States Patent and Trademark Office. Intel, the Intel Inside Logo, Pentium and Celeron are registered trademarks of Intel Corporation. Microsoft and Windows NT are registered trademarks of the Microsoft Corporation in the U.S. and other countries. All other product names mentioned herein may be trademarks of their respective companies.

Compaq shall not be liable for technical or editorial errors or omissions contained herein. The information is provided "as is" without warranty of any kind and is subject to change without notice. The warranties for Compaq products are set forth in the express limited warranty statements accompanying such products. Nothing herein should be construed as constituting an additional warranty.